

INSTALLATION MANUAL - DEA CARMENTA M

PREPARATION:

- The mains isolator on the consumer unit/fuse board must be in "OFF" position before commencing any electrical work.
- The luminaires should be mounted on a flat, smooth surface.
- With all painted / plated products some shade and finishing variation may occur, please make sure luminaires are checked before installation.
- The manufacturer reserves the right to improve the product specification without prior notice.



Do not directly cover fitting with insulation.



RoHS



Installation must be done by a qualified electrician.

DRIVER

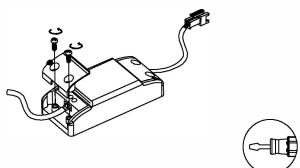

FRONT SIDE

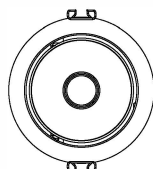

PROFILE

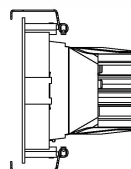

CONNECTION PREVIEW

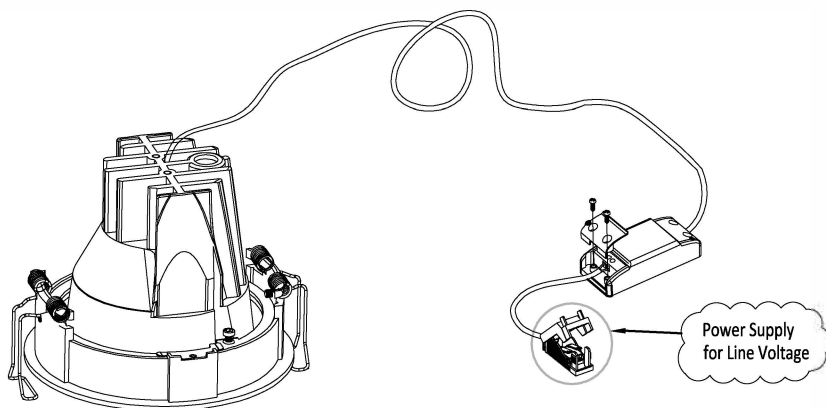

Quick Connection

| REF. | Ø (mm) | C (mm) | H (mm) | S (mm) |
|----------------|--------|--------|--------|--------|
| Dea Carmenta M | 100 | 60 | 100 | Driver |

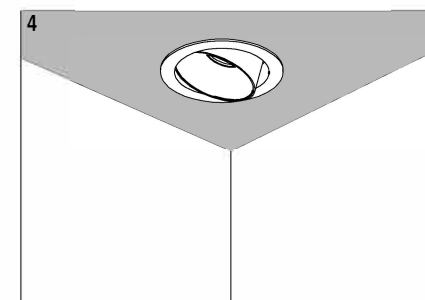
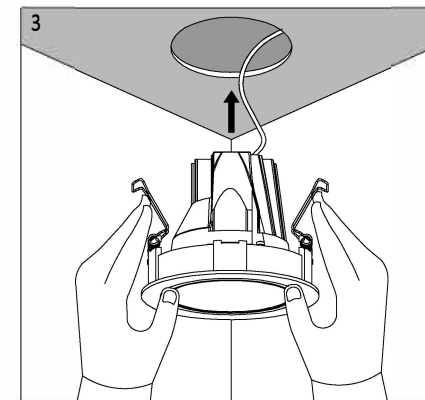
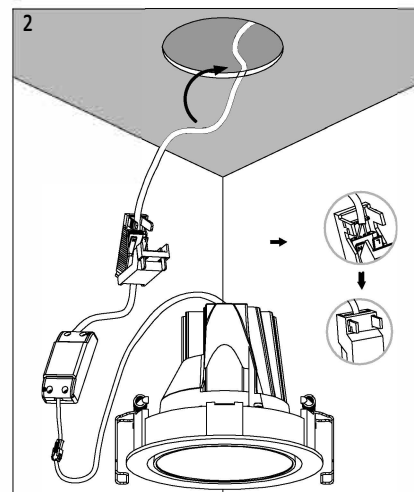
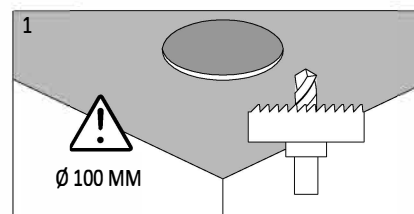
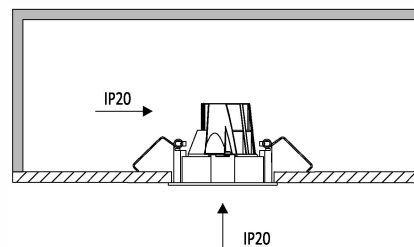

UNINSTALL

